

# Yale®

**SIEVERT**  
**CRANE & HOIST**  
DIVISION OF SIEVERT ELECTRIC

Authorized Sales and Service  
(708) 771-1600  
parts@sievertelectric.com  
www.sievertcrane.com

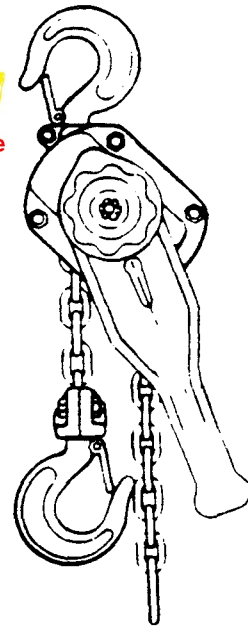

## Hoisting Equipment

### Operation & Service Guide Ratchet Lever Hoist Model PS 3/4 to 6 Ton Capacity

#### SAFE HOISTING PRACTICES

For your own safety and that of your fellow workers, Material Handling Equipment must be used and maintained as recommended by the Manufacturer. Failure to heed the following recommendations could endanger your life. Use good common sense and judgement at all times. Safety is the responsibility of the operator of the equipment. You must be competent and attempt to foresee and avoid all hazardous conditions. To be safe as possible, the hoist must be given proper preventive maintenance and testing as described in the ANSI B30-16 Safety Code for Overhead Hoists and this Manual.

##### BEFORE OPERATING HOIST:

1. Do not operate hoist unless you are properly trained, physically fit, and authorized to do so. You must be familiar with all operating controls of the hoist, warnings, and instructions on the hoist, the safe hoisting practices listed in this Manual, ANSI B30-16 Safety Code for Overhead Hoists, and all pertinent Federal, State, and local regulations before beginning operation.
2. Do not allow unqualified personnel to operate the hoist.
3. Be familiar with the equipment and its proper care. Do not operate hoist if adjustments or repairs are necessary, if any damage or undue wear is known or suspected, or if any warning, operating, or capacity instructions normally attached to hoist are damaged, obscured or missing. Report same promptly to the proper person and also notify next operator when changing shifts.
4. Conduct periodic visual inspections as described in Preventive Maintenance Section of this Manual and make sure necessary lubrication and repairs are made.
5. Do not operate hoist if it is functioning improperly.
6. Do not operate hoist with an out-of-order sign attached until sign has been removed by a properly authorized person.
7. Do not adjust or repair hoist unless qualified for maintenance of hoist.
8. Do not use chain as ground for welding.
9. Do not touch a welding electrode to the chain.
10. Never attempt to motorize or mechanically operate a hoist designed for manual operation.

##### APPLYING THE LOAD:

1. Never wrap the hoist chain around the load, or allow it to drag under load.
2. Use slings or other approved devices to attach load as necessary.
3. Be sure the sling is properly seated in the saddle of the hook. Do not allow hook latch to support any part of load.
4. Do not apply a load to tip of hook, or in such a way as to cause bending or prying forces on the hook or hook support block.
5. Be sure chains are not kinked or twisted or that multiple part chains are not twisted about each other.
6. Do not operate hoist if chain is not seated properly in the sheaves.
7. Center hoist unit over the load before lifting. Avoid side pull.
8. Never pick up a load beyond the rated capacity appearing on the hoist, except for properly authorized tests.
9. Never carry personnel on the hook or the load.
10. Avoid swinging of load or load hook when traveling the hoist.
11. On trolley mounted hoists, avoid sharp contact between trolleys, or between trolleys and rail stops.

##### PARKING:

1. Do not leave a load suspended in the air for extended or unattended periods.
2. Keep load block above head level when not in use.

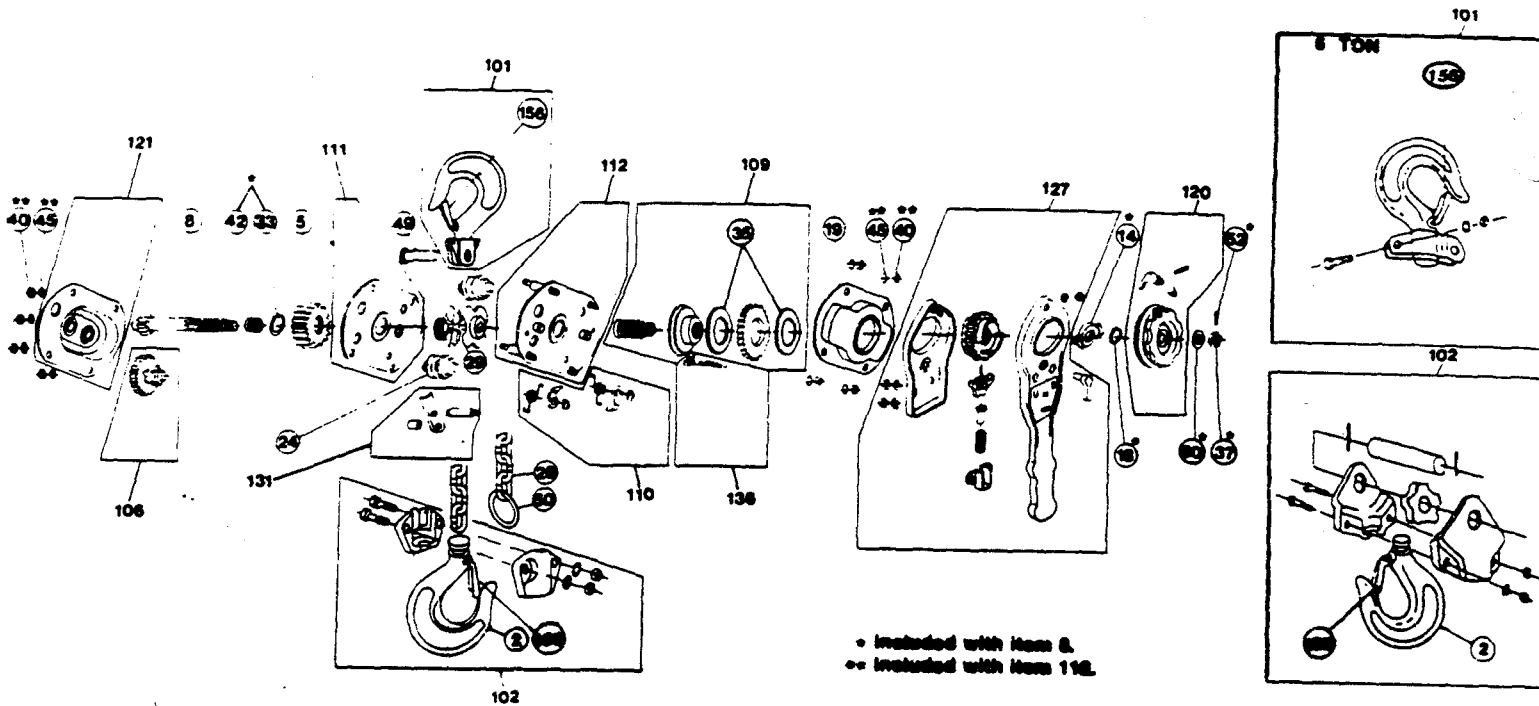

If any of items 8, 35, 14 and/or 18 are replaced on the early models, it is mandatory to order both items 8 and 109.

If either 5 or 29 is replaced, it is mandatory to order both.

Early model brake disc item 35 has an OD of 2.5 and an ID of 1.406.

NOTE: When installing replacement load chain be sure the smooth side of the link mates to the sheave pockets (weld side away from sheave) to assure safe raising and lowering operation and to avoid unnecessary chain or sheave wear.

ITEM	DESCRIPTION	QTY	3/4 TON	1 1/2 TON	3 TON	6 TON
101	TOP HOOK ASM.	1	830-075-101	830-150-101	830-300-101	830-600-101
102	BTM. BLK. ASM.	1	830-075-102	830-150-102	830-300-201	830-600-102
2	BTM. HOOK & LATCH	1	N/A	N/A	N/A	830-600-002
156	SAFETY LATCH KIT	2	830-075-156	830-150-156	830-300-156	830-600-156
5	FIRST GEAR	1	830-075-005	830-150-005	830-300-005	830-300-005
106	2ND & 3RD GEAR	2	830-075-106	830-150-106	830-300-106	830-300-106
8	PINION SHAFT	1	830-075-008	830-150-008	830-300-008	830-300-008
109	BRAKE ASM.	1	830-075-109	830-075-109	830-075-109	830-075-109
35	BRAKE DISC.	2	830-075-035	830-075-035	830-075-035	830-075-035
110	PAWL ASM.	1	830-075-110	830-075-110	830-075-110	830-075-110
111	GEAR SIDE PLATE	1	830-075-111	830-150-111	830-300-111	830-300-111
112	BRAKE SIDE PLATE	1	830-075-112	830-150-112	830-300-112	830-300-112
19	BRAKE COVER	1	830-075-019	830-150-019	830-300-019	830-300-019
120	BRAKE WHEEL ASM.	1	830-075-120	830-075-120	830-075-120	830-075-120
121	GEAR COVER	1	830-075-121	830-150-121	830-300-121	830-300-121
24	SHEAVE GUIDE	2	830-074-024	830-150-024	830-300-024	830-300-024
127	HANDLE ASM.	1	830-075-127	830-150-127	830-300-127	830-600-127
28	LOAD CHAIN	FT.	446-005-731	646-801-300	646-800-300	646-800-300
50	CHAIN END RING	1	830-075-050	830-075-050	830-075-050	830-075-050
29	LOAD SHEAVE	1	830-075-029	830-150-029	830-300-029	830-300-029
131	STRIPPER ASM.	1	830-075-131	830-150-131	830-300-131	830-300-131
136	BRAKE RETAINER KT	1	830-075-136	830-075-136	830-075-136	830-075-136
49	SUPPORT PIN	1	830-075-049	830-150-049	830-300-049	830-300-049
14	CHECK WASHER	1	*830-075-014	*830-075-014	*830-075-014	*830-075-014
42	SPRING	1	*830-075-042	*830-075-042	*830-075-042	*830-075-042
33	SNAP RING	1	*830-075-033	*830-075-033	*830-075-033	*830-075-033
18	SNAP RING	1	*830-075-018	*830-075-018	*830-075-018	*830-075-018
80	FLAT WASHER	1	*830-075-080	*830-075-080	*830-075-080	*830-075-080
37	SLOTTED NUT	1	*830-075-037	*830-075-037	*830-075-037	*830-075-037
52	COTTER PIN	1	*830-075-052	*830-075-052	*830-075-052	*830-075-052
40	HEX NUT	8	**830-075-040	**830-075-040	**830-075-040	**830-075-040
45	LOCKWASHER	8	**830-075-045	**830-075-045	**830-075-045	**830-075-045

Rev. 1/88

PAT 009